



## TSH Swivel hook screw clamps

Working load limit (WLL) 750 - 5000 kg

The TSH 'swivel hook' screw clamps is suitable for many applications. It is particularly useful for lifting and pulling sheet metal, girders, and steel constructions. The clamps are supplied complete with an alloy safety shackle that allows for pulling at 180° degrees.

Product group: I2

## INFO

The surface of the material to be lifted must not exceed a hardness level of HRC 50/Brinell 480.

Supplied with shackle.



## Technical data TSH

Model	Art.-No.	*WLL kg	Jaw capacity Z mm	*Weight kg
TSH750	N51502400	750	0 - 30	3.1
TSH1500	N51502401	1500	0 - 32	7.4
TSH3000	N51502402	3000	0 - 50	11.4
TSH5000	N51502403	5000	0 - 80	27.6

\*Per clamp

## Dimensions TSH

Model	TSH750	TSH1500	TSH3000	TSH5000
A, mm	190	255	290	470
B, mm	52	65	74	130
Ø C, mm	19	26	30	50
D, mm	43	75	85	135
E, mm	113	130	170	225
F, mm	35	44	50	72
X, mm	15	40	40	50

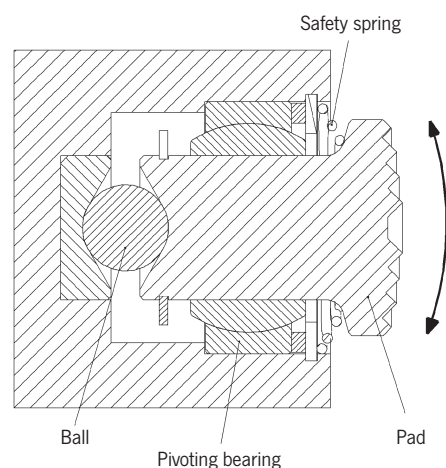
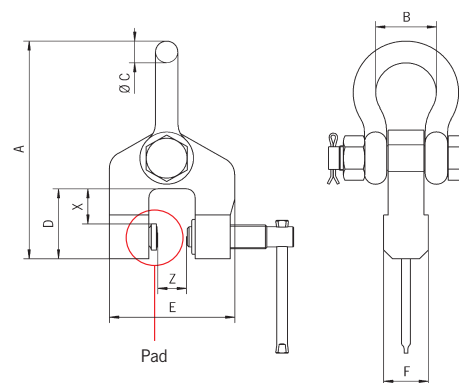

Functional drawing pivoting pad

## TSZ Two way screw clamps

Working load limit (WLL) 500 - 7500 kg

The TSZ 'two way' screw clamps offers many possible uses. Ideally suited for the construction industry. The unique design of the spindle makes it easy to attach to 'angle' plate. This is achieved by simply turning the handle which applies the pressure to the plate holding it securely. Two lifting points enable it to be pulled in two different directions.

Product group: I2

## INFO

The surface of the material to be lifted must not exceed a hardness level of HRC 50/Brinell 480.

Shackles are not supplied.

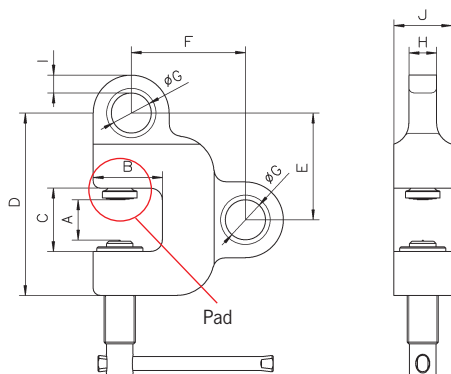

## Technical data TSZ

Model	Art.-No.	*WLL kg	Jaw capacity mm	*Weight kg
TSZ500	N51502410	500	0 - 28	2.3
TSZ1500	N51502411	1500	0 - 35	5.6
TSZ3000	N51502412	3000	0 - 35	8.8
TSZ5000	N51502413	5000	0 - 40	16.2
TSZ7500	N51502414	7500	0 - 40	20.9

\*Per clamp

## Dimensions TSZ

Model	TSZ500	TSZ1500	TSZ3000	TSZ5000	TSZ7500
A, mm	28	35	35	40	40
B, mm	43	60	67	85	92
C, mm	45	55	65	75	75
D, mm	125	158	195	230	240
E, mm	72	93	114	133	143
F, mm	83	99	120	150	162
Ø G, mm	26	35	46	55	65
H, mm	16	24	34	40	50
I, mm	12	16	17	18	23
J, mm	35	50	60	75	80

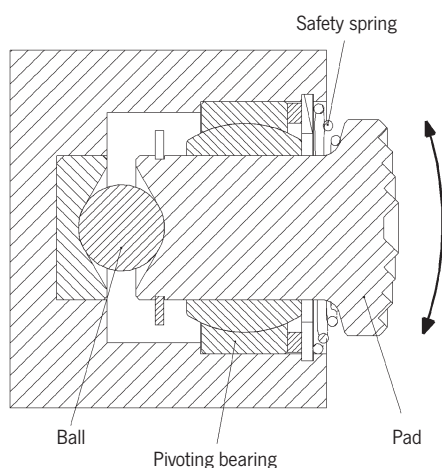

Functional drawing pivoting pad