

## LIFTING SLING FITTINGS FOR WIRE ROPE

## SWIVELS

**Applications**

Thrust bearing swivels are used to prevent wire rope or chain from transferring their normal twisting motion to the item being lifted. Green Pin® swivels without bearings are not designed to rotate under load, but are intended as positioning devices only. For rotation under load, thrust bearing swivels should be used. Our swivels can be supplied with two types of end fittings.

**Design**

Green Pin® swivels (eye-eye/ jaw-eye) are drop forged. Green Pin® thrust bearing swivels are machined from carbon steel. The range of thrust bearing swivels we supply are fitted with grease nipples to ensure long life and smooth operation. The greasing schedule must be adjusted to the frequency and intensity of use.

Each swivel is generally marked with:

- |                                              |              |
|----------------------------------------------|--------------|
| • Working Load Limit                         | - e.g. 2.4 t |
| • manufacturer's symbol                      | - e.g. GP    |
| • traceability code                          | - e.g. A1    |
| • CE conformity code (conformité Européenne) | - CE         |

**Instructions for use**

Swivels should be inspected before use to ensure that:

- all markings are legible;
- a swivel with the correct WLL has been selected;
- the bolt, nut or any other locking system cannot vibrate out of position;
- swivels are free from nicks, gouges and cracks;
- swivels are not distorted or unduly worn.

Also:

- swivels must be used for in-line lifting only;
- swivels may not be heat treated as this may affect their WLL;
- never modify, repair or reshape a swivel by machining, welding, heating or bending as this may affect the WLL.

The WLL should be applied in-line. Avoid overloads. Side loading is not allowed since the swivels are not designed for this purpose. Never replace a swivel pin or nut with a pin other than the one designed for the purpose, as otherwise the swivel may not be suitable for the load imposed. Swivels must be regularly inspected in accordance with the safety standards given in the country of use. This is required because the products in use may be affected by issues such as wear, misuse and overloading, which may lead to deformation and alteration of the material structure. Inspection should take place at least every six months and more frequently when the swivels are used in severe operating conditions.



## Green Pin® EE Swivel

### Swivel with eye-eye end-fitting

- **Material:** high tensile steel, quenched and tempered
- **Safety factor:** MBL equals 5 x WLL
- **Standard:** US Federal Spec. RR-C-271, Type VII, Class 2
- **Finish:** hot dipped galvanized
- **Certification:** 2.1 2.2 CE IIA
- **Article code:** scan QR code to see article codes
- **Note:** for WLL 8.2 t and 20.5 t swivels both eye parts are equipped with a nut

Scan for additional product details

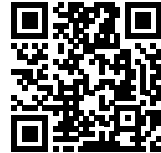

G-7713

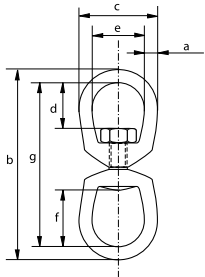

working load limit	diameter	length outside	width outside	length inside	width inside	length inside	length	weight each
t	a mm	b mm	c mm	d mm	e mm	f mm	g mm	kg
0.4	6	87	32	18	19	27	75	0.10
0.6	8	107	41	21	25	32	91	0.18
1.12	10	131	51	24	32	38	111	0.30
1.63	13	164	64	33	38	51	138	0.60
2.4	16	198	76	40	45	61	166	1
3.3	19	221	89	45	51	67	183	1.79
4.54	22	257	102	53	57	78	213	2.55
5.7	25	298	114	59	64	86	248	4.06
8.2	32	357	143	68	80	68	293	8.48
20.5	38	541	198	110	122	110	465	25.7

CAD



## Green Pin® JE Swivel CP

### Swivel with jaw-eye end-fitting and cotter pin

- **Material:** high tensile steel, quenched and tempered
- **Safety factor:** MBL equals 5 x WLL
- **Standard:** US Federal Spec. RR-C-271, Type VII, Class 3
- **Finish:** hot dipped galvanized
- **Certification:** 2.1 2.2 CE IIA
- **Article code:** scan QR code to see article codes



G-7723

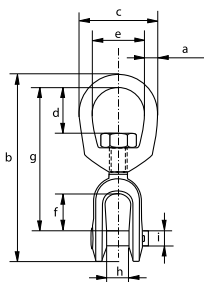

working load limit	diameter	length	width outside	length inside	width inside	length inside	length	width inside	diameter pin	weight each
t	a mm	b mm	c mm	d mm	e mm	f mm	g mm	h mm	i mm	kg
0.4	6	88	32	18	19	22	67	12	6	0.09
0.6	8	99	41	21	25	23	75	13	8	0.16
1.12	10	122	51	24	32	27	92	16	10	0.32
1.63	13	154	64	33	38	33	115	21	13	0.57
2.4	16	184	76	40	45	38	135	26	16	0.98
3.3	19	211	89	45	51	45	154	31	19	1.88
4.54	22	244	102	53	57	52	178	31	23	2.43
5.7	25	297	114	59	64	72	218	47	29	4.02
8.2	32	335	143	68	80	72	240	57	35	7.43
20.5	38	534	198	110	122	116	381	78	51	22.1

CAD



G-7733

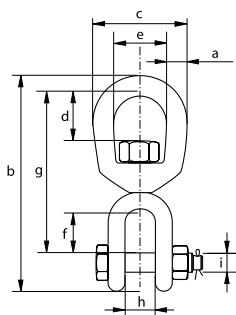

## Green Pin® JE Swivel BN

Swivel with jaw-eye end-fitting and safety bolt

- **Material:** high tensile steel, quenched and tempered
- **Safety factor:** MBL equals 5 x WLL
- **Standard:** US Federal Spec. RR-C-271, Type VII, Class 3
- **Finish:** hot dipped galvanized
- **Certification:** 2.1 2.2 CE IIA
- **Article code:** scan QR code to see article codes

Scan for  
additional  
product  
details



working load limit	diameter	length outside	width outside	length inside	width inside	length inside	length	width inside	diameter pin	weight each
t	a mm	b mm	c mm	d mm	e mm	f mm	g mm	h mm	i mm	kg
0.6	8	99	41	21	25	23	75	13	8	0.16
1.12	10	122	51	24	32	27	92	16	10	0.32
1.63	13	154	64	33	38	33	115	21	13	0.57
2.4	16	184	76	40	45	38	135	26	16	0.98
3.3	19	211	89	45	51	45	154	31	19	1.88
4.54	22	244	102	52	57	53	178	31	22	2.43
5.7	25	297	114	59	64	72	218	47	28	4.02

CAD



P-7740

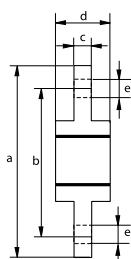

## Green Pin® Thrust Bearing EE Swivel

Swivel with eye-eye end-fitting and thrust bearings

- **Material:** carbon steel
- **Safety factor:** MBL equals 5 x WLL
- **Finish:** painted black
- **Certification:** 2.1 2.2 MTC\* CE IIA
- **Article code:** scan QR code to see article codes
- **Note:** equipped with two thrust ball bearings to enable rotation under load



working load limit	length	length	thickness	diameter	diameter hole	weight each
t	a mm	b mm	c mm	d mm	e mm	kg
1	174	128	12.5	49	21	1.40
2	223	173	19	68	22	3.50
3	278	210	26	79	29	6.40
5	290	222	26	89	31	7.90
8	366	276	40	106	43	15.2
10	390	300	40	118	49	19.1
15	457	355	40	128	49	26.6
20	474	372	40	118	51	25
30	612	472	64	138	59	50
40	760	600	68	168	65	92